

# GENERATORS

## 7333 STATIC GENERATOR

The 7333 Static Generators offer the latest technology in providing safe, controllable power up to 30kV, 1mA for temporary adhesion applications.

Designed for full integration with a machine or production process and available in AC or DC Models.



### Benefits and Advantages

#### Performance

- > The 7333 uses solid state electronics and switching technology for stability and reliability.
- > 0-30kV / 1mA available for continuous output.
- > 2 Models - either 24V DC (7333DC) or 90V - 264V AC operation (7333AC).
- > Fast rise and decay times.
- > Two HV output connections, more connections available with external connector box.
- > Available in positive or negative polarities to be specified at time of order.

#### Control Interface

- > The control interface gives the operator complete control of the functions of the 7333.
- > On - Off switching of the high voltage.
- > High voltage setting and adjustment.
- > Setting and adjustment of current limits.
- > Remote sensing of actual output voltage and current for easy display.
- > For complete ease of installation the 7333 provides a 10V DC supply for all of the above functions - the customer does not need to supply additional power.
- > There is automatic selection of constant current or constant voltage mode.

#### Remote Monitor

- > A remote monitoring system checks the High Voltage output status of the Generator. Voltage free relay contacts are provided to switch an alarm or feedback to a PLC.

#### Reliability

- > Short-circuit and arc protected output.
- > Rugged mechanical enclosure for wall or bench mounting.

#### Safety

- > Multiple levels of protection for market-leading safety in operation.

BOUSSEY CONTROL EUROPE - Jacob Lacopstraat 36 Bus 101 - 9700 Oudenaarde - Belgium

+32 55 423953 - +32 55 612101

Email: [info@boussey-control.eu](mailto:info@boussey-control.eu) - Site Internet: [www.boussey-control.com](http://www.boussey-control.com)



## Specification

### Construction

- > 1.5mm steel with mounting brackets.

### Electrical

#### 7333 - DC

- > Input voltage: 20 - 28 VDC.
- > Input current: Max 3.0A under all operating conditions.
- > M12 4 Pin Connector.

#### 7333 - AC

- > Input voltage: 90V - 264V 50/60Hz.

### Load

- > Two HV output connections. An external connector box is available for additional HV outputs.

### Installation

- > Dry, oil-free location required with max ambient temperature of 40°. Max 70% rH, not wet or condensing.

### Approvals

- > Low Voltage Directive: 2006/95/EC.
- > EMC Directive: 2004/108/EC.

## 7333 Dimensions

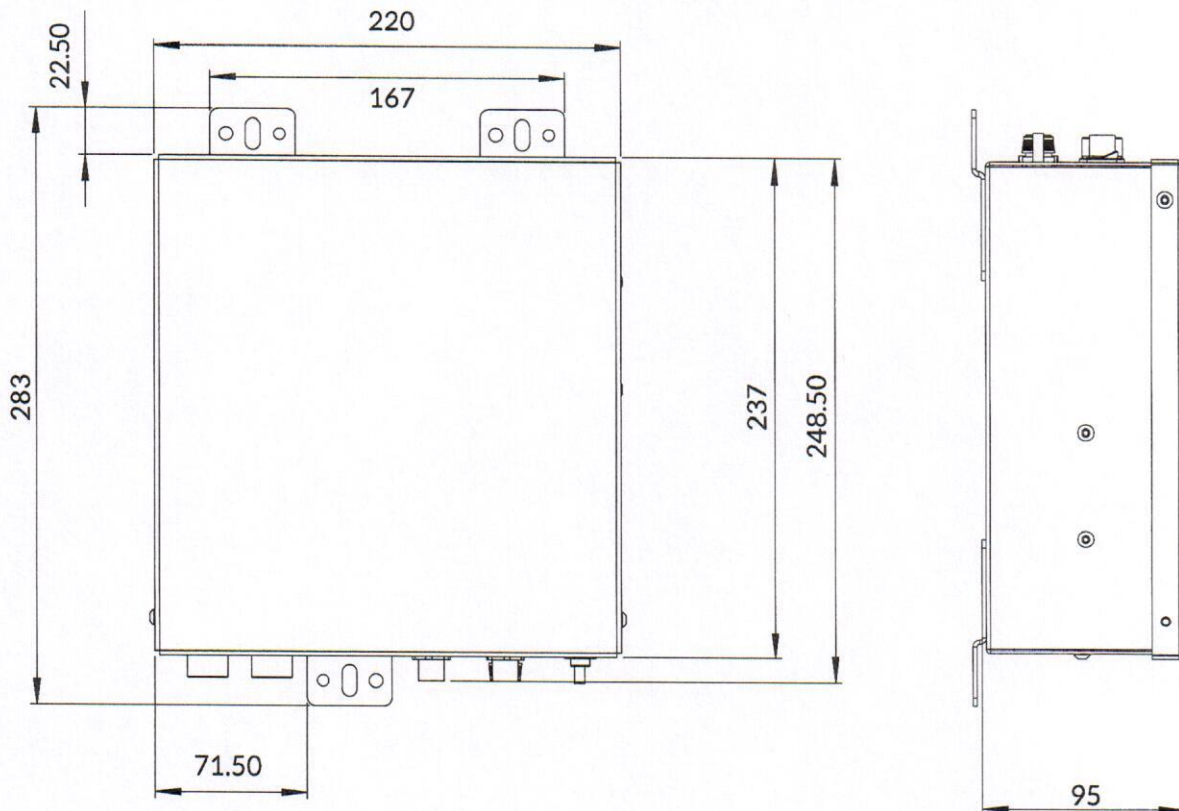

## Accessories

The **7333 DC** is supplied with a 5m 24V DC Power Cable and 5m earth lead as standard. The **7333 AC** is supplied with an integral 5m power lead, a 5m earth lead and a remote monitor.

Please order Control Interface Cable separately - options in table on right.

Description	Part Number
Control Interface M12 x 8 Pin Cable - 5m	80777
Control Interface M12 x 8 Pin Cable - 10m	80978
Remote Monitor M12 x 5 Pin Cable - 5m	80778
Remote Monitor M12 x 5 Pin Cable - 10m	80974
M12 x 4 Pin 24V Power Cable - 5m (included)	80779
Extra m of Mains Cable for AC Version	80308